



Street furniture technical specifications

"MODERN" range

Bicycle Stand A



JMU-0034

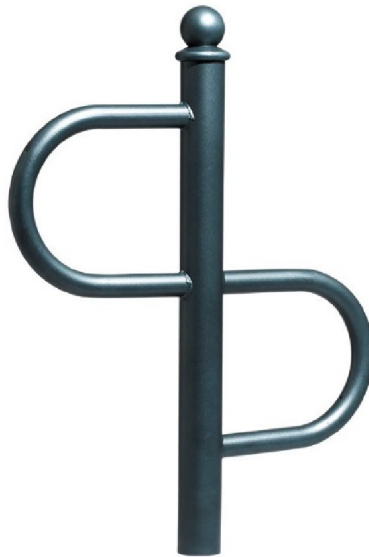

JMU-0034

MODERN range:

The "Modern" range is based on a simple, straightforward composition with a discrete base and solid wooden square slats. The plain and unadorned "Modern" range can be integrated long-term into any type of landscape.

+ Ideas: Full attention has been given to the base of the "Modern" range to make it as discrete as possible without losing any of its stability.

+ Design: The strong visual presence of the bench is created by its shape, thickness and the materials used to make it. These benches are as welcoming as they are reassuring.

+ Quality: The seats are made of softwood or tropical hardwood, also known as "ironwood" due to its exceptional resistance and attractive appearance.

Identification:

| | |
|-----------|------------------|
| Catalogue | Street furniture |
| Range | Modern |
| Pages | 71 |

Dimensional characteristics:

| | |
|--|-------------|
| Bollard dimensions (Lxheight above ground) | 700x1000 mm |
| Total height | 1300 mm |

Material:

| | |
|----------------|---------------------------|
| Structure | Galvanised, painted steel |
| Top of bollard | Galvanised, painted steel |

Standard:

| | |
|-------------|----------------|
| NF EN 335-1 | NOT APPLICABLE |
| NF P 99-610 | Yes |

Installation:

| | |
|-----------------------|---|
| Delivery | Pre-assembled or Kit (depending on version) |
| On-ground fixing type | Direct concreting |

Colour:

| | |
|----------------------------------|----------------|
| Standard body colour * | Black RAL 9005 |
| Top of bollard standard colour * | Black RAL 9005 |

* more than 200 shades available on request

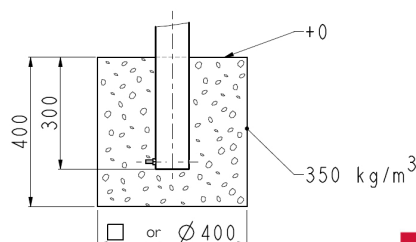
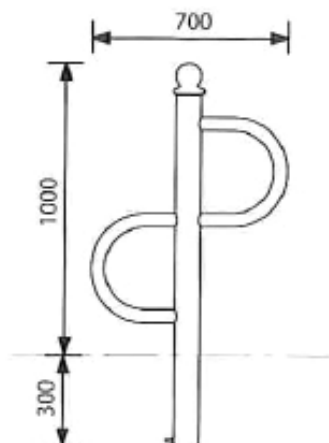

Direct concreting





Street furniture



+ STEEL

Extremely resistant double coating

All our steel sections feature double-surface coating:

- Treatment 1: hot-dip galvanisation after manufacture (on the inside and outside of the tubes)
- Treatment 2: powder coating (oven-cured powder paint)

This double treatment guarantees optimum protection from corrosion.



+ IRON OR ALUMINIUM CASTING

Efficient method

After being removed from the mould, the cast iron or aluminium parts are stripped, sand-blasted and then coated in oven-cured polyester powder at a temperature of 250°C to form a uniform, protective coat of approximately 100 microns.



+ ASSEMBLY

Stainless steel bolts and screws

For the metal assemblies, we systematically use our special vandal-resistant bolts which cannot be unscrewed without a special HUSSON tool.

For the wooden/metal assemblies, we have also developed a special vandal-resistant stainless steel screw.



+ GUARANTEE

Long-term guarantee

Thanks to the quality of the materials used and to our double surface treatment, our furniture is designed to withstand the harshest climates and vandalism, thus guaranteeing the sustainability of investments.



+ WOOD AND POLYMERS

Many possibilities to meet every requirement

- **Tropical hardwood** ("ironwood"): We have chosen an extremely tough tropical hardwood ("ironwood") for its exceptional resistance and attractive appearance. As part of its sustainable development approach, HUSSON International is committed to using wood harvested from forests which are managed in an environmentally responsible manner.
- **Softwood**: Cheaper than hardwood, the softwood selected by HUSSON International has a very attractive appearance and is the number one choice.
- **Recycled materials**: As part of its sustainable development approach, HUSSON International uses recycled materials for its bench slats and litter bins. The selected materials are extremely stain- and scratch-resistant and reduce maintenance to a bare minimum ==> See "WoodTech" technical specification sheet.
- **HPL** (High Pressure Laminate): Extremely tough and wear-resistant, flame-retardant, volume-dyed, easy maintenance, high pressure laminate. Available with a wooden texture for a beautiful effect.
- **Rotation moulded polymers**: The planter and litter bin tubs and some of the street furniture items are made of polymers, generally HDPE (High Density Polyethylene) or PP (Polypropylene). Rotation moulding technology is used to create mechanically-resistant, volume dyed products with complex shapes.



+ WOOD SURFACE TREATMENT

Environmentally-friendly treatment

(For softwood and hardwood)

To improve the long-term durability of the surface coating, and to facilitate their maintenance, we use a vacuum and pressure surface-coating treatment which enables excellent penetration into the wood.

Results:

- Clearly improved durability
- Extremely easy maintenance
- Environmentally-friendly, solvent-free treatment which is safe for users